

VISIBILITY SPLAY - DMURS

X = 2.00m WHERE VEHICLE SPEEDS ARE AND FLOWS ON THE MINOR ARM ARE LOW.
 Y = 23m AT 30km/h SPEED LIMIT BASED ON SPEED LIMIT REVIEW - PHASE 4 MAP ISSUED BY DUBLIN CITY COUNCIL.

VISIBILITY SPLAY - DMURS

X = 2.00m WHERE VEHICLE SPEEDS ARE AND FLOWS ON THE MINOR ARM ARE LOW.
 Y = 14m BASED ON CONSERVATIVELY ASSUMED 20 km/h SPEED LIMIT DESPITE 10 km/h SPEED LIMIT ON SITE.

EXISTING 10 kph SPEED LIMIT SIGN POST ON SITE.



EXISTING 5 kph SPEED LIMIT SIGN POST ON SITE.

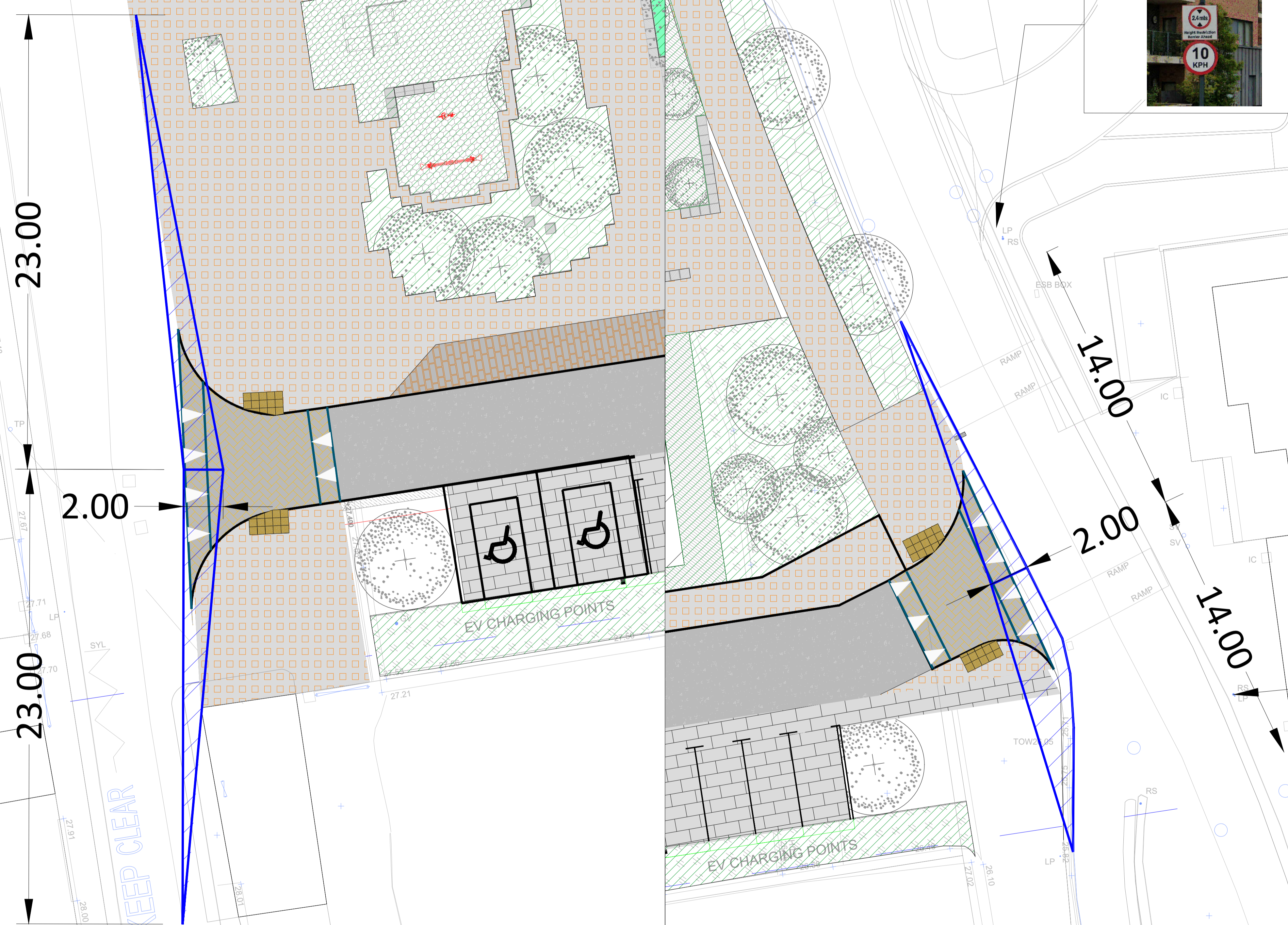

Xref N:\Projects\CDS\CS\DWG\OSI NUMBER_NEW TITLEBLOCK.dwg

- FOR SETTING OUT REFER TO ARCHITECT'S DRAWINGS.
- THIS DRAWING TO BE READ IN CONJUNCTION WITH ALL OTHER ARCHITECTURAL AND ENGINEERING DRAWINGS AND ALL OTHER RELEVANT DRAWINGS AND SPECIFICATIONS.
- DO NOT SCALE THIS DRAWING. USE FIGURED DIMENSIONS ONLY.
- NO PART OF THIS DOCUMENT MAY BE REPRODUCED OR TRANSMITTED IN ANY FORM OR STORED IN ANY RETRIEVAL SYSTEM OF ANY NATURE WITHOUT THE WRITTEN PERMISSION OF O'CONNOR SUTTON CROMIN AS COPYRIGHT HOLDER EXCEPT AS AGREED FOR USE ON THE PROJECT FOR WHICH THE DOCUMENT WAS ORIGINALLY ISSUED.

Rev No.	Date	Revision Note	Drn by	Chkd by
P01	28/09/22	SUITABLE FOR STAGE APPROVAL PLANNING	JT	PR

Rev No.	Date	Revision Note	Drn by	Chkd by

PLANNING DRAWING.
 NOT FOR CONSTRUCTION.
 ALL LEVELS GIVEN ARE
 RELATIVE TO ORDNANCE DATUM.
 THIS DRAWING HAS BEEN ISSUED FOR INFORMATION
 PURPOSES ONLY AND MUST NOT BE USED
 FOR CONSTRUCTION UNDER ANY CIRCUMSTANCES

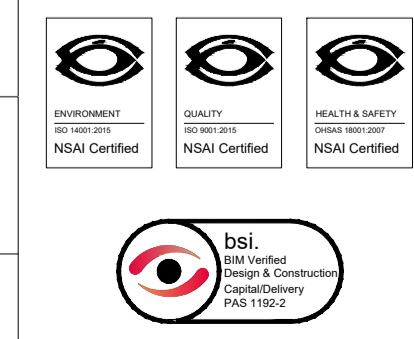

Head Office,
 9 Prussia Street,
 Dublin 7,
 D07 KT57
 TEL +353 (0)1 8682000
 e: contactus@ocsc.ie
 w: www.ocsc.ie
 Dublin | London | Belfast | Galway | Cork



Client: DUBLIN CITY COUNCIL
 Project: PROPOSED DEVELOPMENT AT EMMET ROAD

Title: VISIBILITY SPLAY - SHEET 2 OF 2

Code	Originator	Zone	Level	Type	Role	Number	Status	Revision
B967	OCSC	XX	XX	DR	C	0103	S4	P01

Date: 01.09.22 Scale: @ A1 Drn by:JT Chkd by:PR Aprvd by:PH